

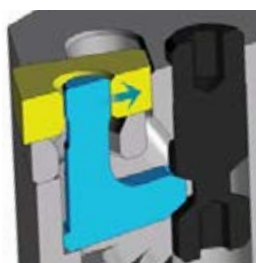

Buy 20 Inserts & get an Internal or External Toolholder **FREE** of charge!

RHINOTURN



Conventional ISO
One directional clamping force

Vs

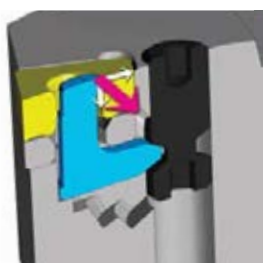

RHINOTURN
Two directional clamping force

CNMG 0904 Inserts from **£4.12**

ADDED BENEFITS:

- Reduced cost, with added durability
- Smaller strong inserts using the standard ISO thickness
- New superior two direction lever clamping system
- Chip breakers & grades to suit all applications
- Other insert styles available: DNMG, WNMG & VNMG

INSERTS	GRADES	COST	DEPTH OF CUT	FEED/ REV	APPLICATION
CNMG0904/04/08 MM	TT9225	£4.12	1.0/4.0	0.2/0.45	Stainless Steel/Steel
CNMG0904/08/12 EM	TT5080	£4.12	1.0/4.0	0.15/0.4	Stainless Steel/High Temp Alloys
CNMG0904/04/08/12 FT	TT8125	£4.12	0.5/3.5	0.15/0.4	Steels
CNMG0904/04/08/12 MK	TT9080	£4.12	1.0/3.0	0.2/0.5	Stainless Steel/Inconel/Stellite
PLUS NEW ALUMINIUM GEOMETRIES COATED & UNCOATED					
CNMG090401/02/04/08 ML	K10	£4.91	1.0/4.0	0.1/0.6	Aluminium
CNMG090401/02/04/08 ML	TT5080	£6.13	1.0/3.0	0.05/0.3	Stainless Steel/Steel Inconel/Superalloys

Prices Exclude VAT.





HCLNR/L HCBNR/L

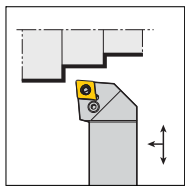

HCLNR/L

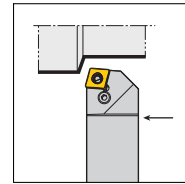
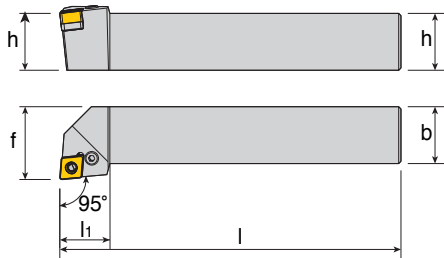

HCBNR/L

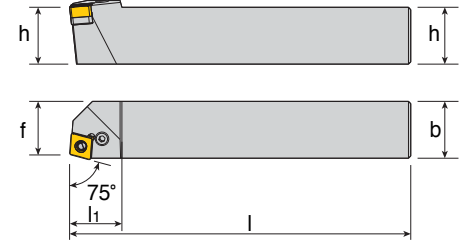

Description		h	b	l	h	f
95°	HCLNR/L 1616 H0904	16	16	100	22	20
	HCLNR/L 2020 H0904	20	20	125	22	25
	HCLNR/L 2525 H0904	25	25	150	22	32
75°	HCBNR/L 2020 K0904	20	20	125	23	18.5
	HCBNR/L 2525 K0904	25	25	150	23	23.5



S-HCLNR/L

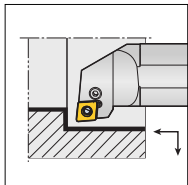

S-HCLNR/L

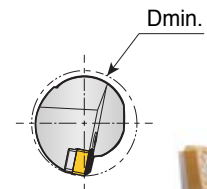
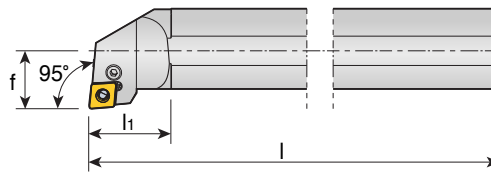
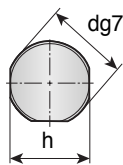

Description	d	h	l	li	f	D
S16Q HCLNR/L 0904	16	15	180	25	11	20
S20Q HCLNR/L 0904	20	18	180	28	13	25
S25R HCLNR/L 0904	25	23	200	31	17	32
S32S HCLNR/L 0904	32	30	250	31	22	40
S40T HCLNR/L 0904	40	37	300	55	27	50

Through coolant bars also available

